

DISPLAYING ITALIAN SCULPTURE:
EXPLORING HIERARCHIES AT THE SOUTH
KENSINGTON MUSEUM 1852-62

TWO VOLUMES

VOLUME 2: ILLUSTRATIONS

CHARLOTTE KATHERINE DREW

PH.D

UNIVERSITY OF YORK

HISTORY OF ART

NOVEMBER 2014



Fig. 1

Charles Thurston Thompson, *Interior of the Art Museum*, c.1859, albumen print
from glass negative, dimensions unknown, V&A Archive, London.



Fig. 2

Andrea della Robbia, *Adoration of the Christ-child*, c.1477, glazed terracotta, 127.8 x 77.4 cm., National Gallery of Art, Washington D.C.



Fig. 3

Minton & Co., *Elephant*, 1889, glazed earthenware, h: 213 cm., Thomas Goode & Co. Ltd., 19 South Audley Street, London.



Fig. 4

Bernard Leach, *Vase*, 1926-7, glazed stoneware, h:16 cm., V&A, London.



Fig. 5

Barbara Hepworth, *Three Forms*, 1935, serravezza marble, 21 x 53.2 x 34.3 cm.,

Tate Modern, London.

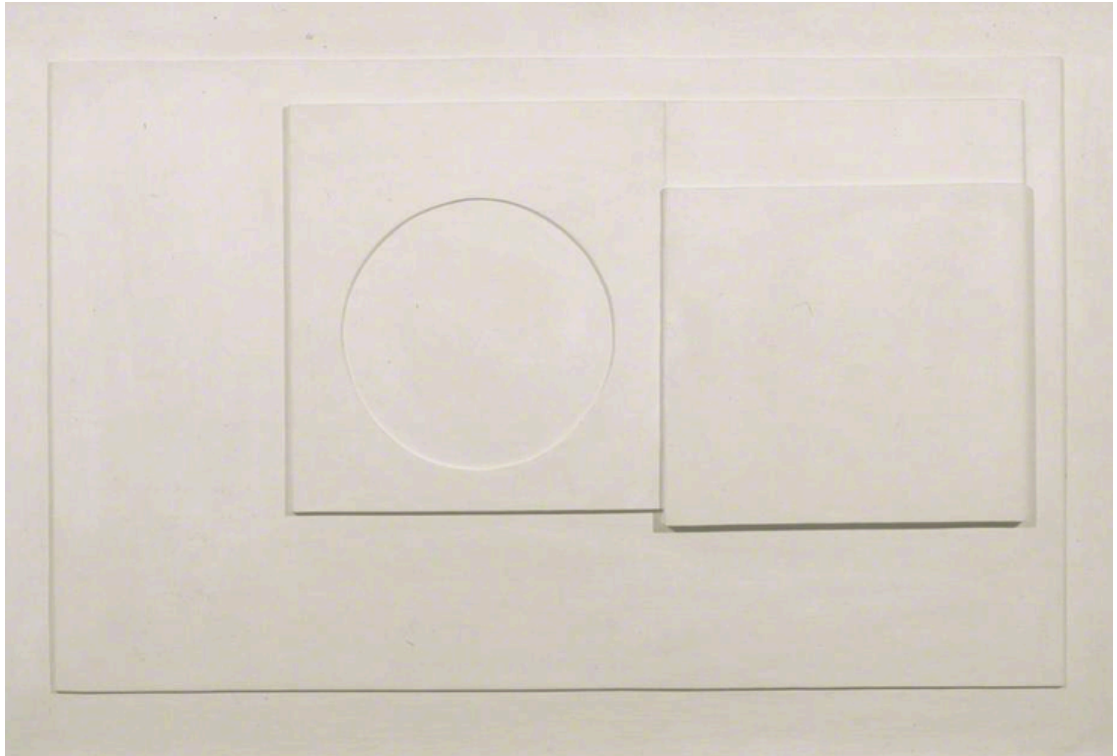

Fig. 6

Ben Nicholson, *White Relief*, 1935, oil on carved wood, 54.5 x 80 cm., British Council Collection.



Fig. 7

Minton & Co., *Ceramic Staircase*, 1865-71, glazed earthenware, V&A Museum, London.



Fig. 8

Unknown, *Ruskin's Study*, c.1910, photograph, dimensions unknown, Walmsley

Brothers/Hulton Archive/Getty Images.



Fig. 9

Louis Reid Deuchars, after a photograph by George Andrews, *George Frederic Watts*, 1899, oil on canvas, National Portrait Gallery, London.



The Drawing-room, Draycott Lodge.

Fig. 10

Unknown, *The Drawing Room, Draycott Lodge*, 1893, photograph, 19 x 14 cm., published in F.W. Farrar and Alice Meynell, *William Holman Hunt: His Life and Work* (London: Art Journal Office, 1893).

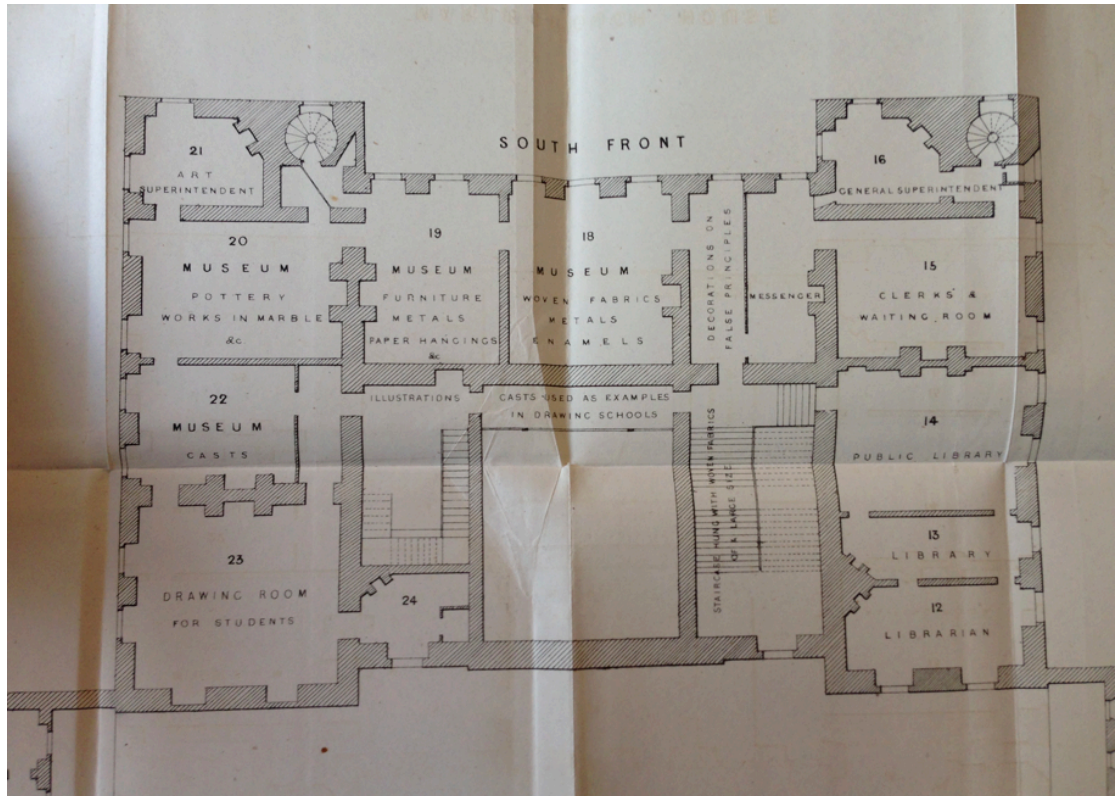

Fig. 11

Floorplan of Marlborough House 1852, published in Department of Practical Art,
First Report of the Department of Practical Art, 1852.



Fig. 12

Domenico Guidi, *Pope Alexander VIII*, c.1690, bronze, 97.2 x 91.4 cm., V&A

London, Museum No. 1089-1853.



Fig. 13

Domenico Guidi, *Pope Innocent X*, c.1690, bronze, 93 x 85 cm., V&A, London,

Museum No. 1088-1853.



Fig. 14

Lorenzo Ghiberti, *Gates of Paradise*, 1425-52, bronze, Baptistery of St. John,

Florence.



Fig. 15

Unknown, *Male Écorché Figure*, c.1550-60, cast red wax, h: 16.5 cm., V&A,
London, Museum No. 4115-1854.



Fig. 16

Unknown, after Michelangelo, *David*, c.1580, red wax, h: 9.4 cm, V&A, London,
Museum No. 4106-1854.



Fig. 17

Unknown, *Anatomical Figure*, c.1550-1600, wax on copper wire, h: 47.9 cm.,

V&A, London, Museum No. 4114-1854.



Fig. 18

Giambologna, *The Rape of the Sabines*, c.1579-1580, modelled wax, 19.6 x 7.65 cm., V&A, London, Museum No. 4125-1854.



Fig. 19

Giambologna, *Florence Triumphant over Pisa*, 1565, wax, 25 x 9.8 cm., V&A,

London, Museum No. 4118-1854.

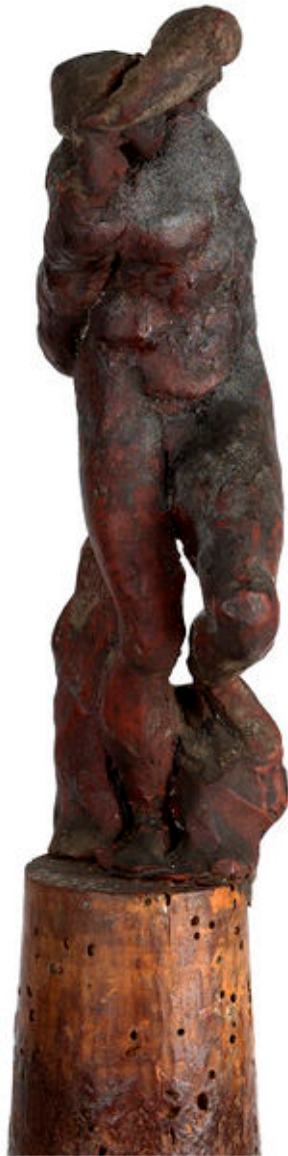

Fig. 20

Michelangelo, *A Slave*, c.1516-1519, wax, 17.6 x 5 cm., V&A, London, Museum

No. 4117-1854.



Fig. 21

William Linnaeus Casey, *Marlborough House: Second Room*, 1857, watercolour,

33 x 22.4 cm., V&A, London, Museum No. 7280.



Fig. 22

Andrea della Robbia, *Virgin and Child*, c.1480-1525, enamelled terracotta, d: 53.3 cm., V&A, London, Museum No. 651-1865.



Fig. 23

Luca della Robbia, *Adoration of the Kings*, c.1475-1500, enamelled terracotta,
41.91 x 60.96 cm., V&A, London, Museum No. 651-1865.



Fig. 24

Giuseppe de Levis, *Firedog with Figure of Juno*, 1550-60, bronze, V&A, London,
Museum No. 3011: 0 to 8-1857.



Fig. 25

Giuseppe de Levis, *Firedog with Figure of Jupiter*, 1550-60, bronze, V&A,

London, Museum No. 3012-1857.



Fig. 26

Unknown, *Francesco Cinzio Benincasa*, c.1478-1480, marble, 58.4 x 54.7 cm.,

V&A, London, Museum No. 653-1865.

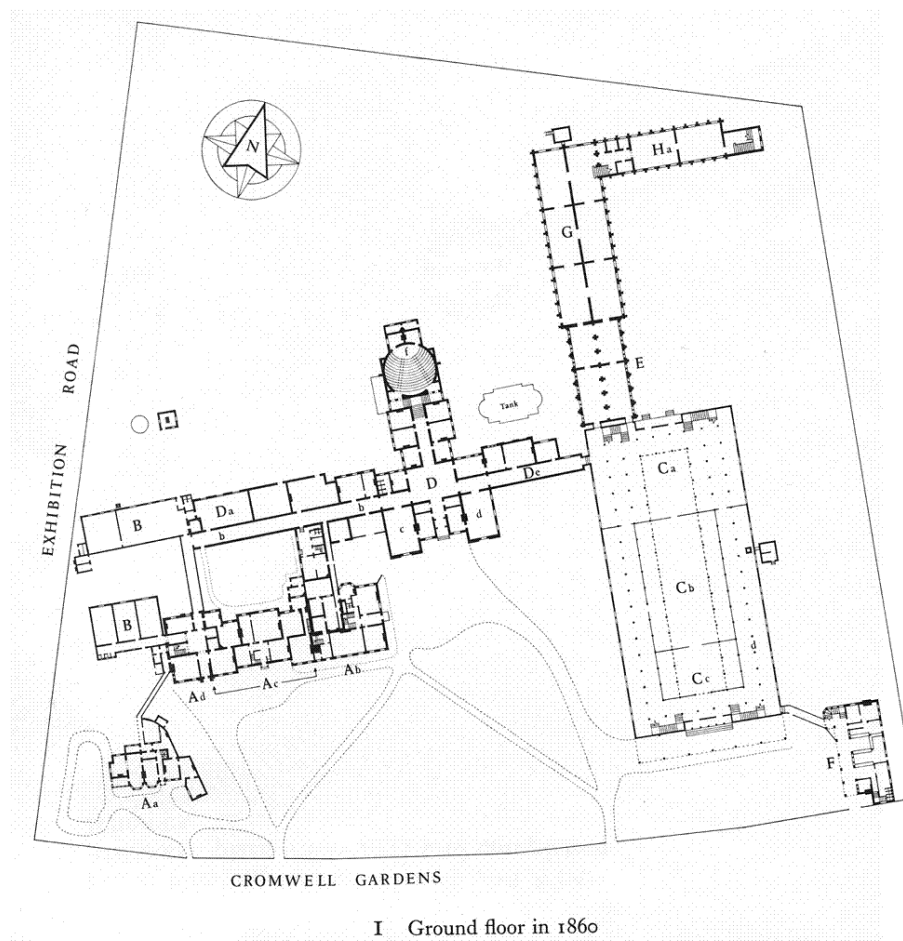

- A. Brompton Park House
- B. School of Art (Male School)
- C. Brompton Boilers.
 - a. Art Museum. Sculpture (gallery above).
 - b. Education Museum. Architectural Museum (western gallery above).
 - c. Patent collection. Architectural Museum (western gallery above).
 - d. Museum of Construction. Food and Animal Products Museums (eastern gallery above).
- D. Lecture Theatre Area
- E. Sheepshanks Gallery (1856-7) (first floor). Museum of Ornamental Art (ground floor)
- F. Refreshment Rooms
- G. Vernon and Turner Galleries (1859) (first floor) Art library (1859-84) and Museum of Ornamental Art (ground floor).
- H. Female School.

Fig. 27

Ground Floor in 1860 [South Kensington Museum], published in Sheppard, F. H.

W., Survey of London, vol. 38 (1975).



Fig. 28

Unknown, after Michelangelo, *David*, c.1857, plaster cast, 541.5 x 213.5 cm.,

V&A, London, Museum No. REPRO.1857-161.



Fig. 29

Andrea Ferrucci, *The Ferrucci Altarpiece*, c.1493, white and red marble with traces of paint, 365.8 x 275.3 cm., V&A, London, Museum No. 6742:59-1859.



Fig. 30

Luca della Robbia, *Stemma of King René of Anjou*, c.1466-78, glazed terracotta, d:

335.3 cm., V&A, London, Museum No. 6740:7-1860.



Fig. 31

Desiderio da Settignano, *Chimney Piece*, c.1466-70, sandstone, 254 x 374.9 cm.,

V&A, London, Museum No. 5896-1859.



Fig. 32

Nicola Pisano, *The Archangel Gabriel*, c. 1260, marble, 96 x 34.3 cm, V&A,
London, Museum No. 5800-1859.



Fig. 33

[The Art Museum at South Kensington], 1861, engraving, published in the
Illustrated Times, 1861.

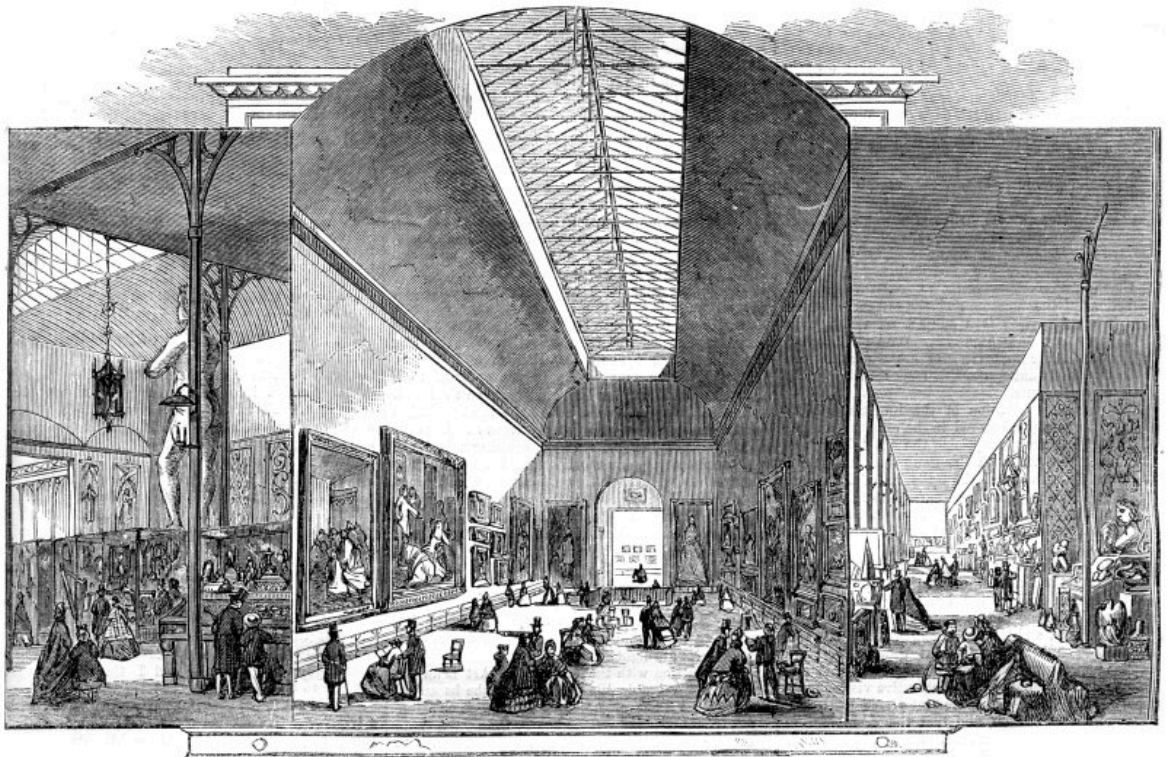

Fig. 34

[South Kensington Museum, 1862], 1862, engraving, *The Probert Encyclopedia*.



Fig. 35

Eliseus Libaerts, *The Cellini Shield*, c.1562-3, blued metal overlaid with silver and gold, d: 58.4 cm., Royal Collection Trust.



Fig. 36

Francis Bedford, *Works of Art Exhibited at Marlborough House 1854: Silver Vase by Vechte*, 1854, albumen print, 21 x 13.5 cm, Royal Collection Trust.



Fig. 37

Antoine Vechte, *The Italian Poets Shield*, 1851, steel, dimensions unknown, V&A,
London, Museum No. 1482-1851.



Fig. 38

Arthur H. Roberts, *Le Cabinet de Charles Sauvageot au 56 rue du Faubourg-Poissonnière à Paris*, 1856, oil on canvas, Musée du Louvre, Paris.



Fig. 39

Unknown, *Chambre du François Ier à l'hôtel de Cluny*, c.1838, engraving from
Alexandre du Sommerard, *Les Arts du Moyen Âge*, Musée de Cluny, Paris.



Fig. 40

William Linnaeus Casey, *Marlborough House: First Room*, 1856, watercolour,
26.5 x 34.3 cm., V&A, London, Museum No. 7279.



Fig. 41

Charles Armytage, *Marlborough House: Sixth Room*, 1857, watercolour, 29.7 x

39.5 cm., V&A, London, Museum No. 7282.



Fig. 42

John C. L. Sparkes, *Marlborough House: Fourth Room*, 1856, watercolour, 31.7 x 30.7 cm., V&A, London, Museum No. 7281.



Fig. 43

Chippendale, *Mirror*, 1762-5, carved and gilded pine, mirror glass and brass, 213.5

x 137 cm., V&A, London, Museum No. 2388-1855.



Fig. 44

Charles Thurston Thompson, *Exterior View of the South Front Entrance of the South Kensington Museum*, 1862, albumen print, 23.7 x 28.6 cm., V&A, London,

Museum No. 33:966.



Fig. 45

Department of Science and Art (commissioned by), *Interior View of the Architectural and Cast Gallery at the South Kensington Museum*, c.1860, albumen print, 23.8 x 29.4 cm., V&A, London, Museum No. 32:053.



Fig. 46

Department of Science and Art (commissioned by), [*Interior View of the British Sculpture Gallery?*], albumen print, dimensions unknown, V&A Archives, London.



Fig. 47

Department of Science and Art (commissioned by), *Interior View of the Patent Museum, South Kensington Museum, 1859*, albumen print, 23.8 x 29.2 cm., V&A, London, Museum No. 32:057.



Fig. 48

Department of Science and Art (commissioned by), *Interior View of the Educational Museum, South Kensington Museum, 1859*, albumen print, 24.8 x 30 cm., V&A, London, Museum No. 32:055.

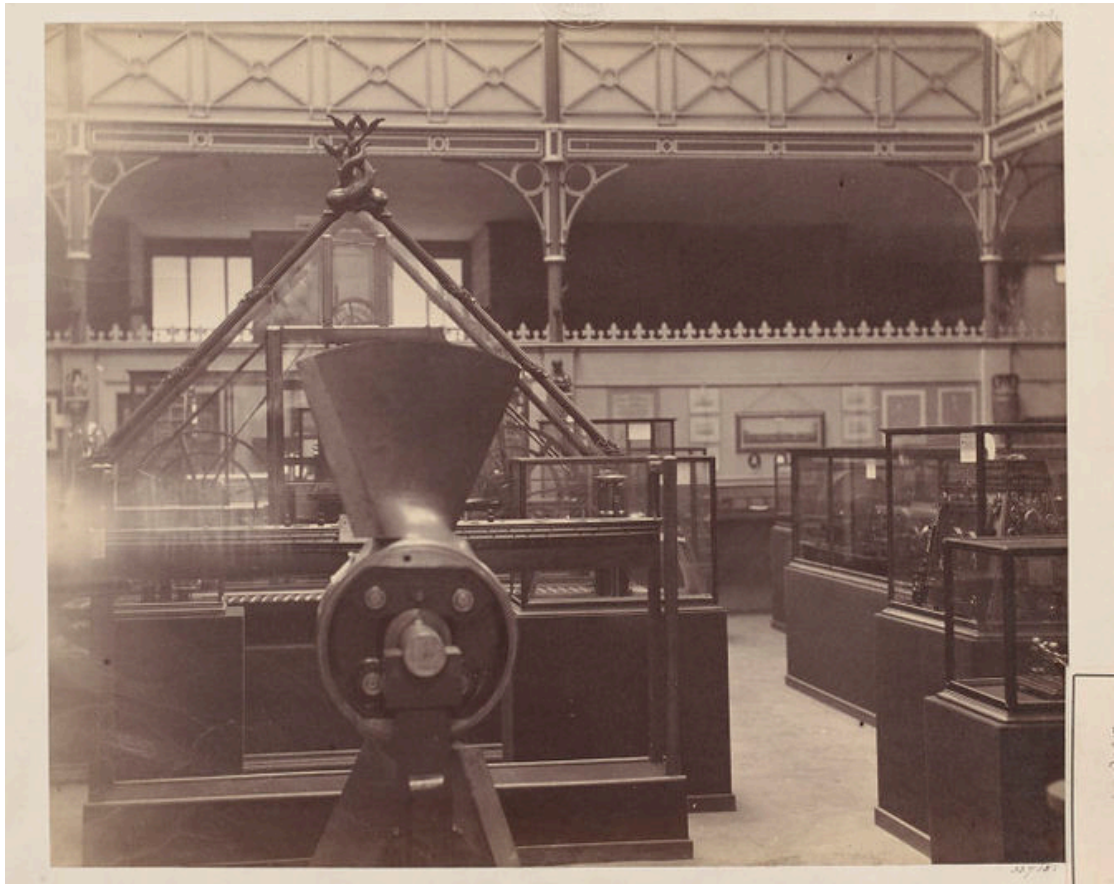

Fig. 49

Department of Science and Art (commissioned by), *Interior View of the Patent Museum, South Kensington Museum*, 1857-64, albumen print, 23.4 x 28.7 cm.,

V&A, London, Museum No. 33:965.

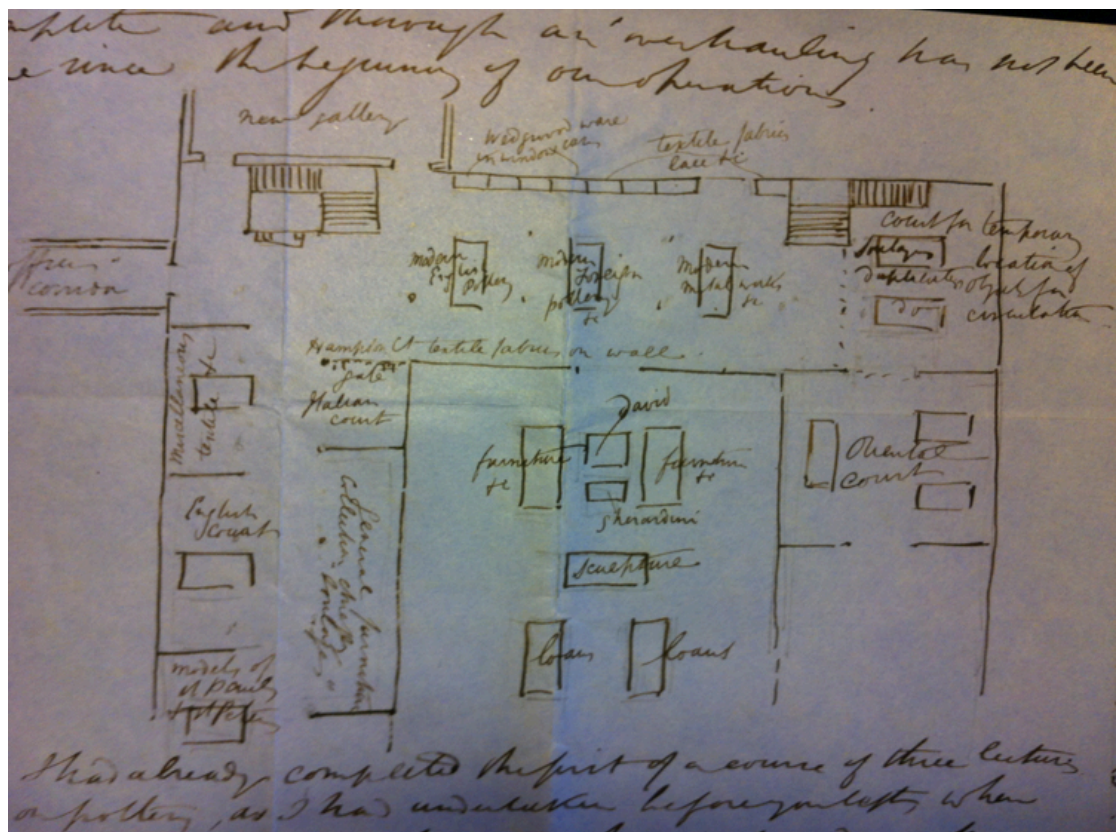

Fig. 50

Robinson's Floor Plan of the Museum of Ornamental Art at the South Kensington Museum, 1858. Taken from a letter to Cole, 4 Dec 1858. Robinson Papers, NAL.



Fig. 51

Minton & Co., *Jardinière*, c.1854, majolica glazed earthenware, dimensions unknown, Potteries Museum, Stoke-on-Trent.



Fig. 52

Unknown, after Raphael, *St. John the Baptist*, c.16th century, oil on poplar panel,

127 x 104 cm., V&A, London, Museum No. 5470-1856.



Fig. 53

Augustin Henckel, *Adoration of the Magi*, c.1500-20, painted and gilded limewood and pine, 129.6 x 121.4 cm., V&A, London, Museum No. 2418-1856.



Fig. 54

Unknown, *Chandelier*, c.1480-1520, brass, h: 98.1 cm, V&A, London, Museum

No. 2398-1855.

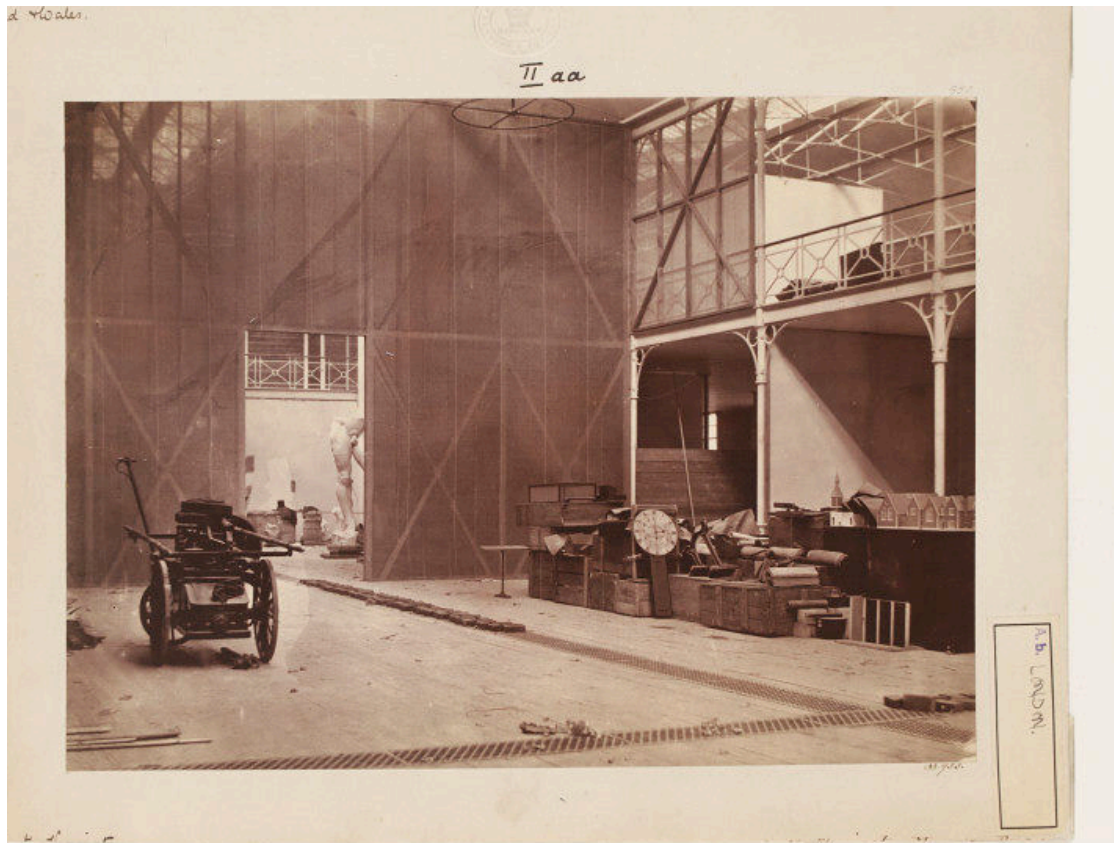

Fig. 55

Charles Thurston Thompson, *South Kensington Museum, Nave with engine and part of 'David,'* 1856, albumen print, 24.8 x 28.5 cm., V&A, London, Museum No.

E.1074-1989.



Fig. 56

Minton & Co., *Bacchus Vase*, c.1854, majolica glazed earthenware, dimensions unknown, Potteries Museum, Stoke-on-Trent.



Fig. 57

Giambologna, *Fountain of Neptune*, 1565, bronze and stone, dimensions unknown,

Piazza Maggiore, Bologna.



Fig. 58

Santi Buglioni, *Frieze*, c.1525, enamelled terracotta, dimensions unknown,
Ospedale del Ceppo, Pistoia.



Fig. 59

*Photograph of the interior of the Renaissance Court at the Crystal Palace, Sydenham, c.1924, published in Buckland, Henry James. *Crystal Palace*. London:*

Photocrom Co. [1924]

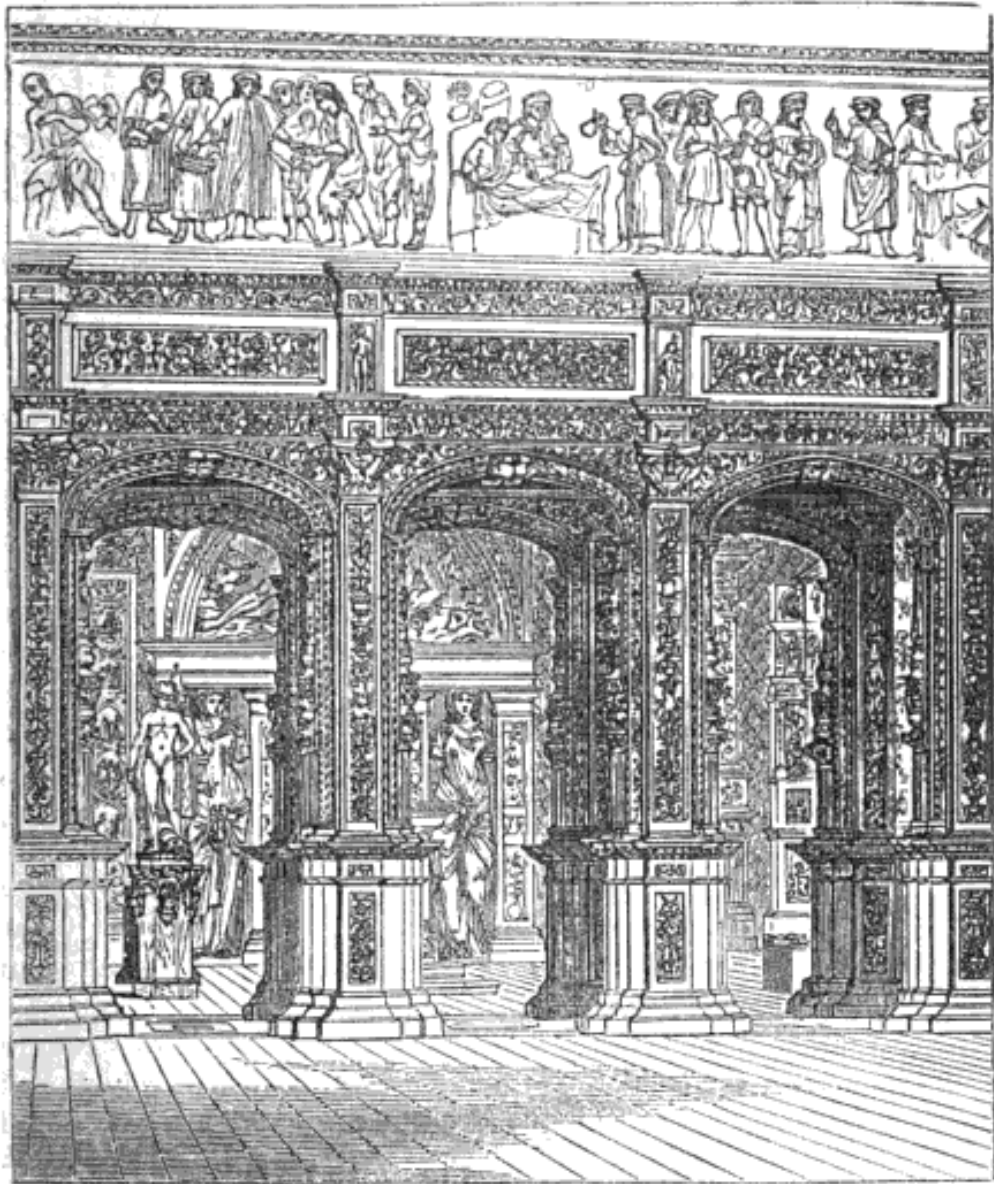

Entrance to Renaissance Court.

Fig. 60

Illustration of the Entrance to the Renaissance Court at the Crystal Palace, 1858,
published in Phillips, Samuel. *Guide to the Crystal Palace and its Parks and*
Gardens. Shenton, F. K. J. ed. London: Bradbury and Evans, 1858.



Fig. 61

Luca della Robbia, *Cantoria*, 1431-38, marble, dimensions unknown, Museo dell'Opera del Duomo, Florence.



Fig. 62

Luca della Robbia, *North Sacristy Doors with the Resurrection*, 1442-75, bronze and glazed terracotta, dimensions unknown, Duomo, Florence.



Fig. 63

Andrea della Robbia, *Adoration of the Magi*, c.1500-10, glazed terracotta, 221.7 x

184 cm. V&A, London, Museum No. 4412-1857.



Fig. 64

William Gersham Collingwood, *John Ruskin in his Study at Brantwood*, 1881, oil
on canvas, dimensions unknown, Ruskin Museum, Coniston.



Fig. 65

Minton & Co., *Peacock*, 1873-80, majolica glazed earthenware, Walker Art Gallery, Liverpool.



Fig. 66

Photograph of the Minton Peacock in the Potteries Museum, Stoke-on-Trent, 2014,
photograph, author's own.



Fig. 67

*Photograph of the Minton Peacock in the Walker Art Gallery, Liverpool, 2014,
photograph, author's own.*



Fig. 68

Unknown, *The Martin Brothers in the Studio at the Southall Pottery*, 19th Century, photograph, dimensions unknown, Bridgeman Art Library.



Fig. 69

Robert Wallace Martin, *Jar*, 1891, glazed stoneware, V&A, London, Museum No.

C6&A-1976.

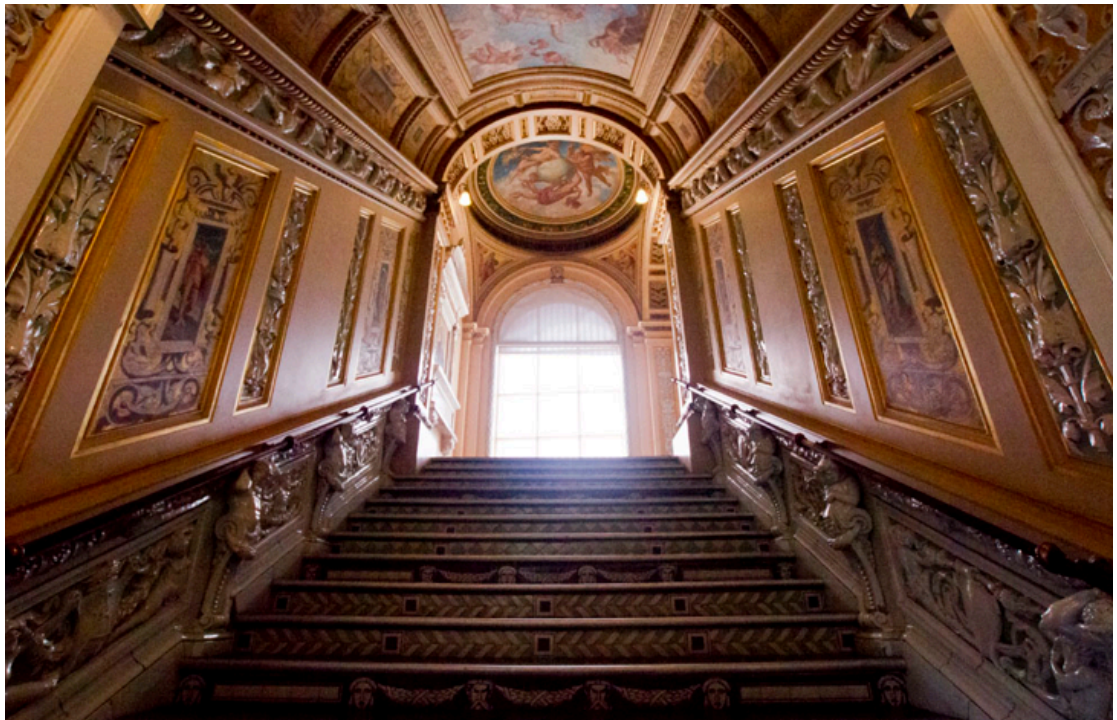

Fig. 70

Minton & Co., *Ceramic Staircase*, 1865-71, glazed earthenware, V&A, London.



Fig. 71

Minton & Co., *Ceramic Staircase*, 1865-71, glazed earthenware, V&A, London.



Fig. 72

John Watkins, *Ceramics Galleries*, 1876, engraving, V&A, London, Museum No.

E819-1945.



THE MAJOLICA FOUNTAIN IN THE INTERNATIONAL EXHIBITION.
DESIGNED BY THE LATE JOHN THORNTON. MANUFACTURED BY MINTON, DILLON AND CO.

Fig. 73

Minton & Co., *St. George's Fountain*, 1862, majolica glazed earthenware, lost.



Fig. 74

Luca della Robbia, *Labours of the Month: January*, c.1450-6, glazed terracotta, d:

59.7cm., V&A, London, Museum No. 7632-1861.



Fig. 75

Minton & Co., *Ceramic Staircase*, example of *Fictile Vitrification*, 1865-71, glazed earthenware, dimensions unknown, V&A, London [photograph, author's own].



Fig. 76

Minton & Co., *Ceramic Staircase, example of Fictile Vitrification, First Floor Roundel*, 1865-71, glazed earthenware, dimensions unknown, V&A, London.



Fig. 77

Frank Moody and Florence Cole, *Henry Cole Memorial*, 1868, majolica glazed earthenware and mosaic, dimensions unknown, V&A, London.



Fig. 78

Minton & Co., *Roundel on the First Floor Landing, Ceramic Staircase*, 1865-71,
glazed earthenware, dimensions unknown, V&A London.



Fig. 79

Minton & Co., *Example of S&A Motif, Ceramic Staircase*, 1865-71, glazed earthenware, dimensions unknown, V&A London. [photograph, author's own].



Fig. 80

Gaspere Paoletti, *Sala della Niobe*, Uffizi Gallery, Florence.



Fig. 81

Appartements d'Anne d'Autriche, Antiquités Romaines, 1655-58, Salle 27, Louvre, Paris.



Fig. 82

Raphael Sanzio da Urbino, *Loggia Frescoes*, c.1508, Vatican, Vatican City.



Fig. 83

Minton & Co., *Dish*, 1862, glazed earthenware, 33 x 26 cm., V&A,

LondonMuseum Number: 8112-1863.



'Majolica' roundel.
'Pallas' with a olive wreath in her hair and
surrounded by a garland of olive leaves and
fruit.

Fig. 84

Minton & Co., *Majolica Roundel*, c.1870s, glazed earthenware, Potteries Museum,
Stoke-on-Trent [photograph, author's own].



Fig. 85

Minton & Co., *Example of Corn Panel, Ceramic Staircase*, 1865-71, glazed earthenware, dimensions unknown, V&A, London [photograph author's own].



Fig. 86

Wedgwood, *Vase*, c.1785, jasperware, 27.3 x 12.7 cm, V&A, London, Museum No. 1421-1855.



Fig. 87

Minton, *Vase*, 1862, porcelain with pâte-sur-pâte decoration, 30.5 x 17.1cm., V&A,

London, Museum No. 8090-1863.



Fig. 88

Minton, *Majolica ware*, 1859, lead-glazed earthenware, 22.9 x 20 cm., V&A,
London, Museum No. 6931-1860.



Fig. 89

Minton [Victor Etienne Simyan, designer], *Vase*, 1867, majolica glazed earthenware, 121.9 x 52.6 cm., V&A, London, Museum No. 1047:1, 2-1871.



Fig. 90

Ford Madox Brown, *Trial of Wycliffe*, 1873-93, mural, dimensions unknown,
Manchester Town Hall, Manchester.



Fig. 91

Conrad Dressler, *John Ruskin*, 1888 (cast), bronze, h: 17.1 cm., National Portrait Gallery, London.



Fig. 92

*Lecture Theatre Block, South Kensington Museum, 1864-6, terracotta, South
Kensington, London.*



Fig. 93

Victoria Law Courts, 1886-91, terracotta, Corporation Street, Birmingham.



Fig. 94

Constitutional Club, c.1886, Northumberland Avenue, London (demolished).



Fig. 95

Conrad Dressler, *Boy and Lanthorn*, 1883, glazed earthenware, Williamson Art Gallery, Birkenhead.



Fig. 96

Donatello, *St. John the Baptist*, 1438, painted wood, h: 141 cm., Santa Maria

Gloriosa dei Frari, Venice.



Fig. 97

Conrad Dressler, *Boy and Lanthorn*, date, stone carving, 16 Hans Road,
Knightsbridge, London.



Fig. 98

William Holman Hunt, *Harold Rathbone*, 1893, oil on canvas, Walker Art Gallery, Liverpool.



Fig. 99

Luca della Robbia, *Madonna in a Lily Bower*, date unknown, glazed terracotta, 48 x 38 cm., Palais Liechtenstein, Liechtenstein.



Fig. 100

Mary Seton Watts, *Watts Mortuary Chapel Exterior*, 1896-8, mixed media, Watts Chapel, Compton, Surrey.



Fig. 101

Hamo Thornycroft, *Mower*, 1882-94, bronze, h: 190.5 cm., Walker Art Gallery, Liverpool.



Fig. 102

Conrad Dressler, *The Sower*, c.1895, glazed earthenware, c. 90 x 60 cm.,

Birkenhead Central Library, Birkenhead.



Fig. 103

Conrad Dressler, *The Reaper*, c.1895, glazed earthenware, c. 90 x 60 cm.,

Birkenhead Central Library, Birkenhead.



Fig. 104

Conrad Dressler, *Lupercalia*, 1907, bronze, dimensions unknown, Walker Art Gallery, Liverpool.



Fig. 105

*The Della Robbia Pottery, c.1898. photograph published in *The Sketch* (March 1898).*



Fig. 106

Carlo Manzoni photographed in the large back room at 28 Argyle Street, at work on a large kneeling figure of Mary Magdalen; c.1898-1900, c.1898-1900, photograph, dimensions unknown, Private collection.



Fig. 107

Carlo Manzoni, *Green Man*, 1898-1904, glazed ceramic, Birkenhead Central Library, Birkenhead.



Fig. 108

Carlo Manzoni, *Mary Magdalen*, c.1899, glazed ceramic, h: 26 cm., Manchester

City Art Gallery, Manchester.



Fig. 109

Charles Collis, *Jar*, c.1896, glazed ceramic, h: 18 cm., Private Collection.



Fig. 110

Arthur E. Bellis and Annie Jones, *Large Plaque*, c.1897, glazed ceramic, d: 36.5 cm., Williamson Art Gallery, Birkenhead.



Fig. 111

Unknown (Italian), *Maiolica Plaque*, c.1525-65, tin-glazed earthenware, d: 24.1 cm., Museum of Fine Arts, Boston.



Fig. 112

Miss C. A. Walker, *Pandora*, 1898, glazed ceramic, 88 x 55 cm., Williamson Art Gallery, Birkenhead.



Fig. 113

Alice Louisa Jones, *Vase*, c.1904, glazed ceramic, h: 34.5 cm., Williamson Art Gallery, Birkenhead.



Fig. 114

Della Robbia Pottery, *William Morris*, 1897, glazed earthenware, 45 x 36 cm.,

Williamson Art Gallery, Birkenhead.



Fig. 115

Ellen Mary Rope (designer), *Guardian Angel*, c.1895, glazed earthenware, 49 x 48 cm., Williamson Art Gallery, Birkenhead.



Fig. 116

Della Robbia Pottery, *Vase*, 1894, glazed ceramic with sgraffito design, National Museums Liverpool.



Fig. 117

George Frampton, *Music*, 1894, painted plaster, Ashmolean Museum Oxford.



Fig. 118

Luca della Robbia, Section of *Cantoria*, 1431-38, marble, Museo dell'Opera del
Duomo, Florence.



Fig. 119

Robert Anning Bell and George Frampton, *Altarpiece*, 1890, mixed media,
dimensions unknown, St. Clare's Church, Sefton Park, Liverpool.



Fig. 120

Robert Anning Bell, *Mother and Children*, 1897, painted plaster, location unknown.



Fig. 121

Luca della Robbia, *The Visitation*, c.1445, glazed terracotta, dimensions unknown,
Church of S. Giovanni Fuoricivitas, Pistoia.



Fig. 122

Robert Anning Bell, *The Meeting of the Virgin and St. Elizabeth*, 1910, tempera on linen, 39.7 x 31.7 cm., Manchester City Art Gallery, Manchester.



Fig. 123

Edward Burne-Jones, *Perseus and the Graiae*, 1877, mixed media, National Museum of Wales, Cardiff.



Fig. 124

Edward Burne-Jones, *Days of Creation: Day Three*, 1870-6, mixed media, Fogg Museum, Harvard Art Museums, Cambridge, MA.



Fig. 125

Marianne de Caluwé, *Days of Creation: Day Three*, 1906, glazed earthenware,

Potteries Museum, Stoke-on-Trent.



Fig. 126

Conrad Dressler, *William Morris*, 1892, bronze, dimensions unknown, Art Worker's Guild, Queen's Square, London.



Fig. 127

Conrad Dressler, *Liverpool Imports Cattle and Wool for Food and Clothing*,

c.1901, stone, dimensions unknown, St. George's Hall, Liverpool.



Fig. 128

Conrad Dressler, *Liverpool by its Imports Supplies the Country with Food and Corn*, c.1901, stone, dimensions unknown, St. George's Hall, Liverpool.

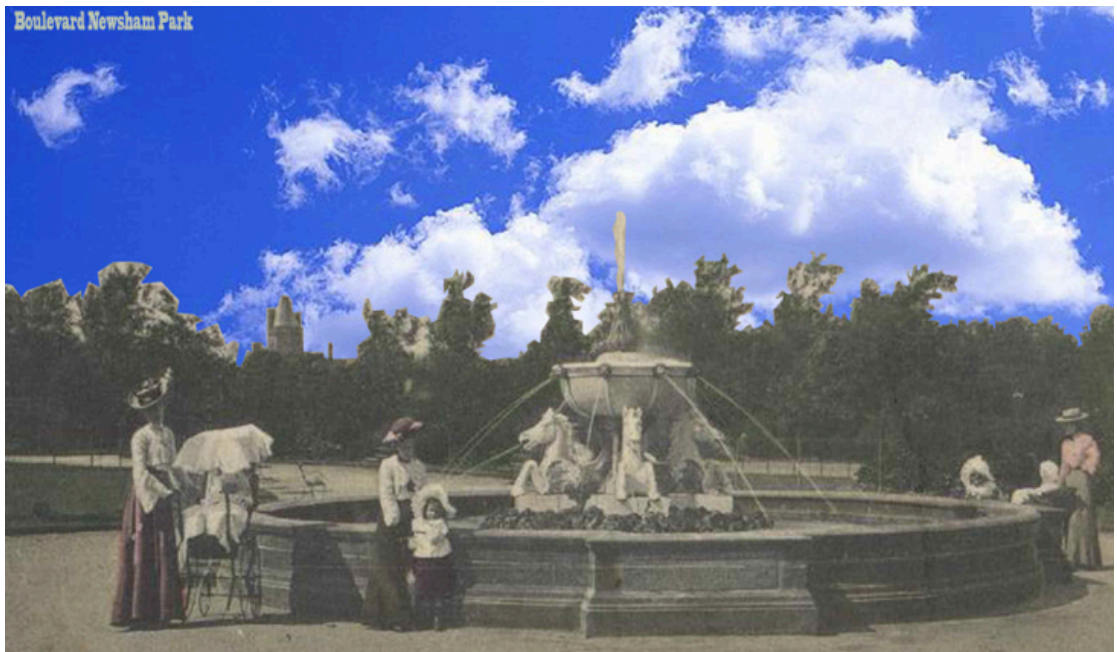

Fig. 129

Conrad Dressler, *Fountain*, 1900, glazed ceramic, dimensions unknown, Newsham Park, Liverpool (destroyed).



Fig. 130

Conrad Dressler, *Fountain*, 1889, glazed ceramic, dimensions unknown, Savoy
Hotel, London (destroyed).



Fig. 131

Benjamin Creswick, Section of *Frieze*, 1887, terracotta, Cutler's Hall, Warwick Lane, London.



Fig. 132

Conrad Dressler, *Frieze*, 1901, glazed earthenware, dimensions unknown, Sunlight Chambers, Parliament Street, Dublin.



Fig. 133

Conrad Dressler, Section of *Frieze*, 1901, glazed earthenware, Sunlight Chambers, Parliament Street, Dublin.



Fig. 134

Santi Buglioni, Section of *Frieze*, c.1525, enamelled terracotta, Ospedale del Ceppo, Pistoia.



Fig. 135

After Santi Buglioni, *Visiting the Sick*, c.1890, plaster cast, h: 140 cm.V&A,

London.



Fig. 136

Sir George Gilbert Scott, *Albert Memorial*, c.1875, Kensington Gardens, London.